

### General information about completion of delivery:

- Doors arrive fully assembled with installed glass from the factory.
- Holes for installation will be predrilled and adjufixes attached on the frame.
- Preparation and insulation of openings of the building should be defined before installation works. It is responsibility of the customer, architect and dealer.

## Installation material

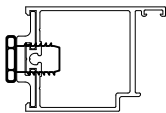

### 1. Adjufix

Required quantity is already attached to the frame.

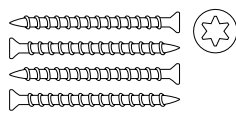

### 2. Screws

For fastening brackets to the wall.  
Not included in delivery.



### 3. Caps

For covering predrilled holes.  
Included in delivery.



### 4. Wedges

Not included in delivery.

## Installation tools

Not included in delivery.



### 1. Cordless screwdriver

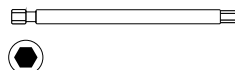

### 2. Hexagonal screwdriver bit.

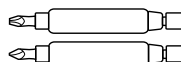

### 3. Magnetic bits



### 4. Drill

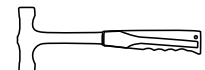

### 5. Light hammer

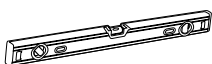

### 6. Spirit level



### 7. Angle

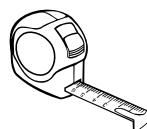

### 8. Tape-measure

### Step 1

#### Door installation to the opening

If possible, depending on situation on site, while fixing the frame, opened sash can be supported with no need to remove it out of the frame. If there is no support possibility, please follow sash removal instruction.

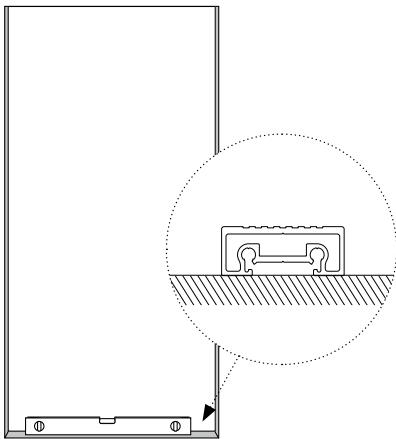

**Step 1.1** Prepare the opening for installation. The entire base under threshold must be flat and level.

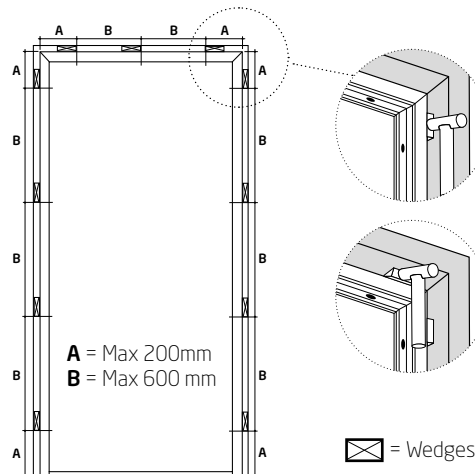

**Step 1.2** Fix the frame with wedges. Wedges must be positioned next to each fixing point on the doorframe.

**NB!** The gap between the frame and the wall is recommended to leave: 15-20 mm

**Step 1.3** Ensure horizontal and vertical leveling of the frame.

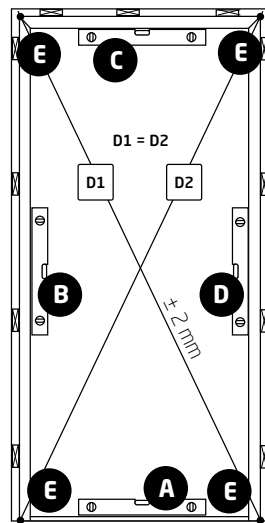

Frame jambs must be square and plumb in both directions and the diagonals (D1 and D2) should be identical.

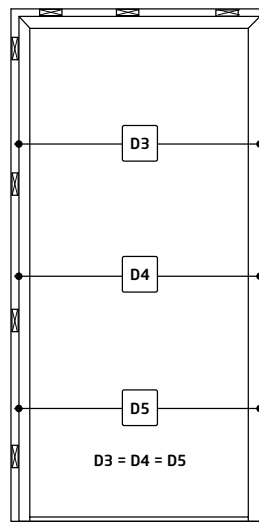

Check the rebate widths are equal across the hinge and locking points (D3, D4 and D5).

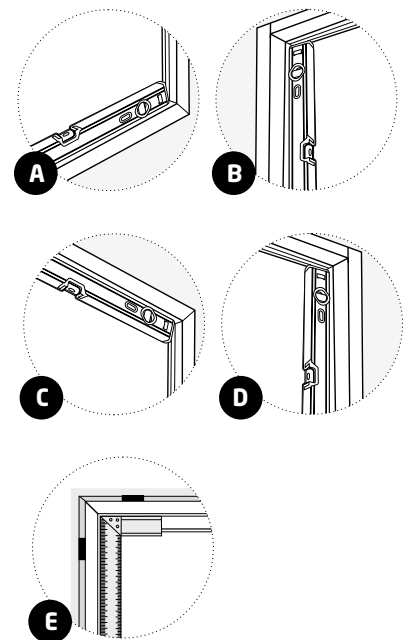

**Step 1.4** Fix the frame with adjufix sleeves into the opening. Open the sash in 90 degrees and support it while fixing the frame to opening with the help of Hexagonal screwdriver bit. Start from the hinges side!

**NB!** It is not necessary to fasten top frame if width is under 1200 mm

**Attention!**

Always use wedges or setting blocks between door frame and wall regardless of chosen installation alternative.

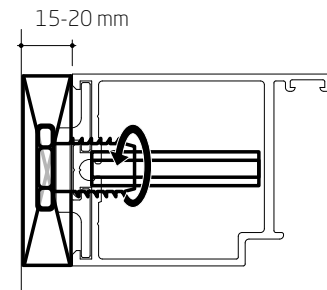
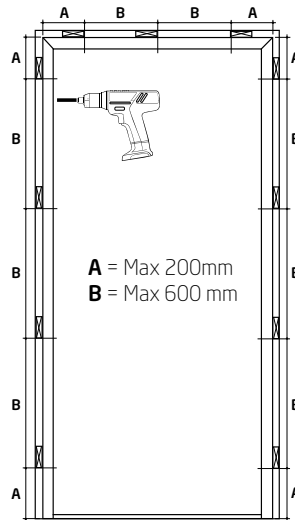

## Step 2

### Fasten the door to the wall

**Step 2.1** Screw bolts through adjufix sleeves on the frame. Recommended distance and depth of drilling according to the type of the wall is shown in the scheme on the right. Cover pre-drilled holes with caps for finishing.

**NB!** It is not necessary to fasten top frame if width is under 1200 mm

**Step 2.3** Ensure horizontal and vertical leveling of the frame. Follow STEP 1.3 instructions.

**Step 2.4** Install the sash back to the frame if it was removed before installation. Follow the sash installation instruction.

**Step 2.5** Check the functionality of sash. Adjust if needed.

**NB!** All the bearing pads and wedges should be left in places!

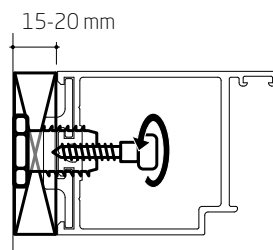
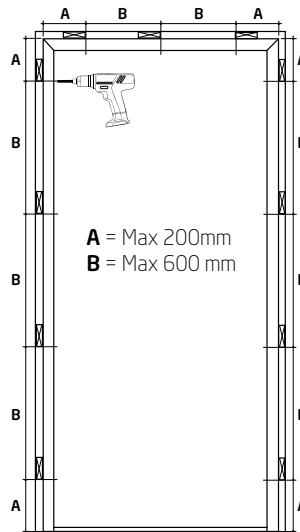

Depth of drilling according material:

100:90:80:70:60:50:40:30: mm

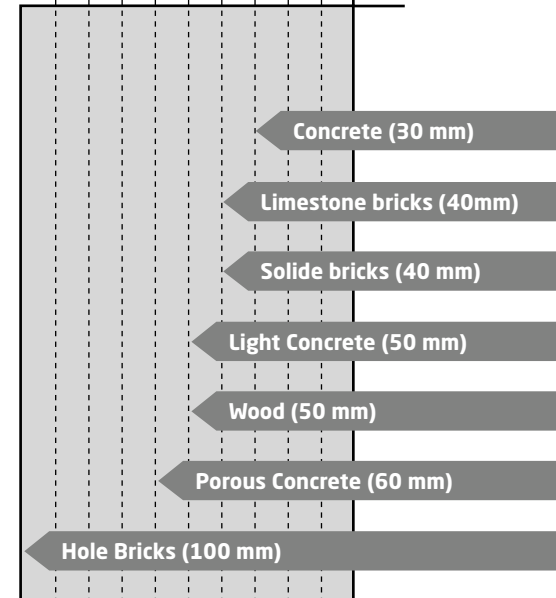

It is not recommended to fasten doors into wooden carcass due to the high risk of wood deformation due to environmental impact (Cold/Heat)