

General information about the completion of delivery:

- The doors arrive fully assembled from the factory with glass installed.
- The required quantity of mounting brackets (art. nr. C02077) are packed separately in a box together with screws for fastening to the frame (art. nr. 12165). The screws for brackets for fastening to the wall are not included.
- The preparation and insulation of the openings of the building should be carried out before installation works. This is responsibility of the customer, architect and dealer.
- **Important!** The parts are not load bearing. External weight must therefore not stress the structure. In the case of very small, or no deflection by the upper structure, a rigid attachment can be used.

Installation materials:

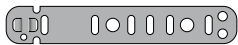

1. Brackets (C02077)

Required quantity included in delivery.

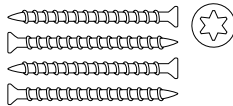

2. Screws

For fastening the brackets to the wall. Not included in delivery.

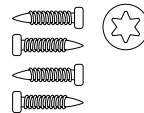

3. Screws (12165)

For fastening brackets. Required quantity included in delivery.



4. Wedges

Use stable, waterproof material, eg plastic. Not included in delivery.

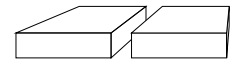

5. Bearing pads

Use stable, waterproof material, eg plastic. Not included in delivery.

Installation tools:

Not included in delivery.



1. Cordless screwdriver

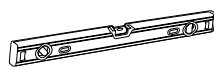

2. Spirit level

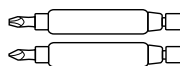

3. Magnetic bits



4. Drills

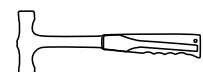

5. Light hammer

6. String or laser for leveling

Sliding door preparation

Fasten all required brackets to the frame according to the instructions below.

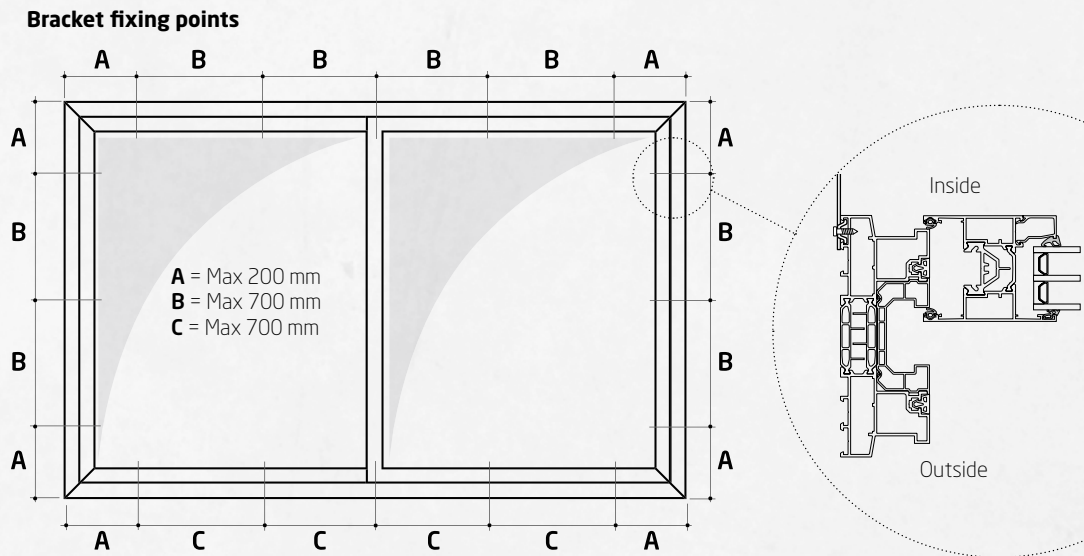

Step 1

Bracket fastening steps

Fasten mounting brackets (C02077) to the frame by screws 12165.

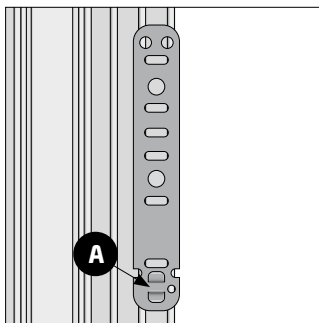

Step 1.1 The bracket should be fitted in one line of the profile. Bracket 'knobs' should be fitted in grooves (A).

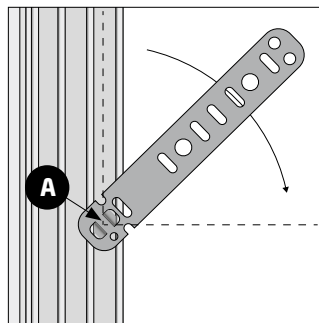

Step 1.2 Turn the bracket through 90 degrees.

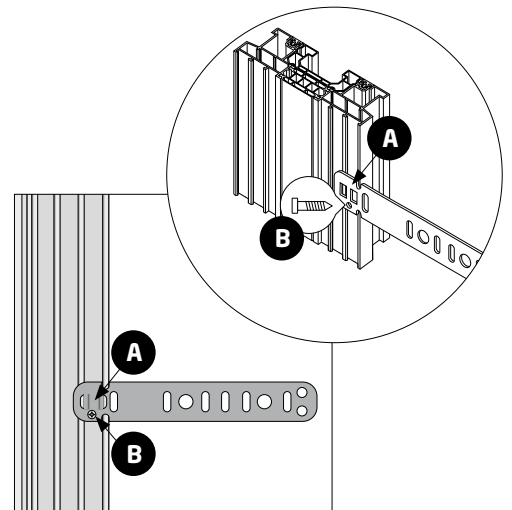

Step 1.3 The bracket should be fastened to the frame with a screw. One pc./bracket (B).

NB! Fastening the mounting brackets with screws at the bottom frame is not required.

Step 2 Door installation in the opening

Prepare the opening for installation. The entire base under the threshold must be flat and level. The base must be firm and steady to tolerate a heavy weight.

NB! If the base is of concrete a DPC must be placed under the whole length of the threshold.

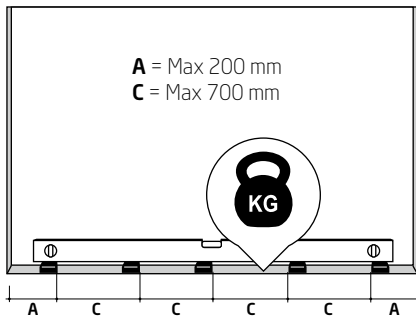

Step 2.1 Place bearing pads at the bottom of the opening next to each fixing point on the door. The number of bearing pads must correspond to the number of fixing points. Ensure they are level.

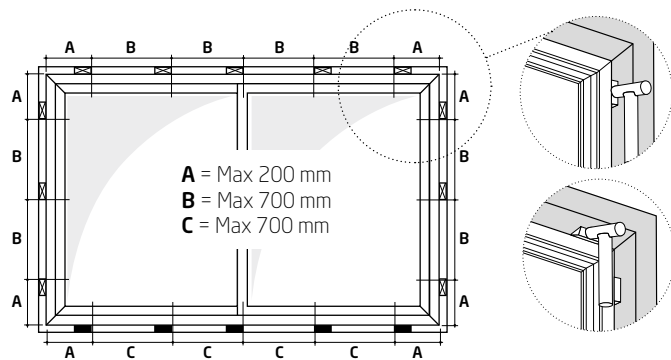

Step 2.2 Fix the frame with wedges into the wall opening. The wedges must be positioned next to each fixing point on the frame.

- = Wedges
- = Bearing pads

NB! For the gap between the frame and the wall it is recommended to leave: 10-20 mm.

Step 2.3 Ensure horizontal and vertical leveling of the frame.

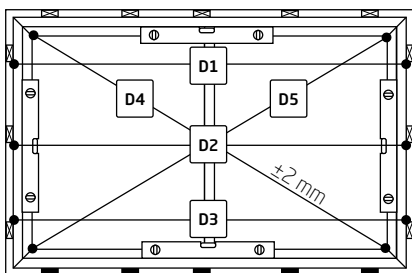

D = Distance **D1=D2=D3** **D4 = D5 (±2 mm)**

Level out using a spirit level.

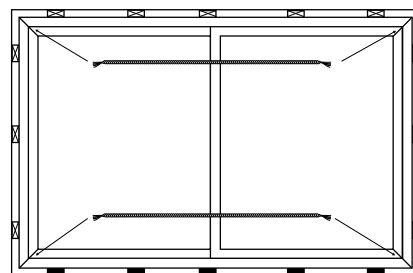

In the case of wide frame profiles, leveling of the top and bottom frame can be checked by using a laser or string.

Straighten the string from one side to another to see if whole profile is level.

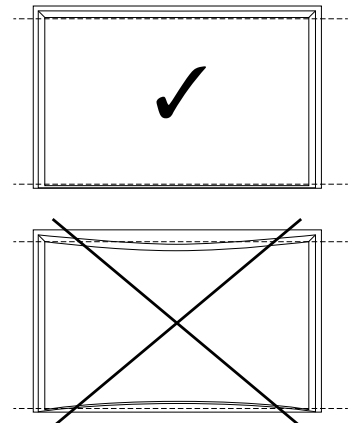

Bracket bending

Bend all the brackets in an required angle to fit the distance to the wall.

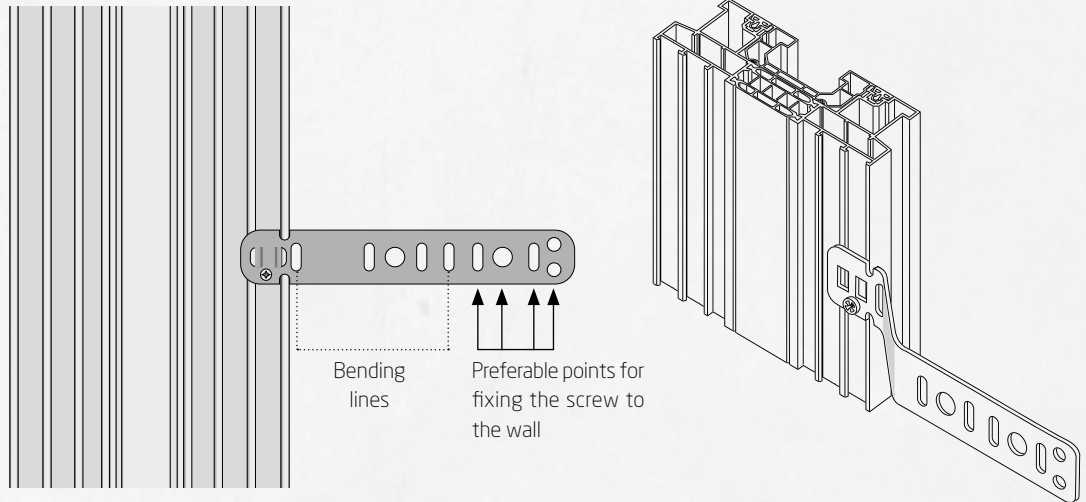

Step 3 Fasten the sliding door

Step 3.1 Screw bolts through brackets. Recommended distance and depth of drilling according to the type of the wall is shown in the scheme to the right.

Step 3.2 Ensure horizontal and vertical leveling of the frame. Follow STEP 2.3 instructions.

Step 3.3 Check functionality of sliding sash.

Step 3.4 Seal the gap between the frame and wall.

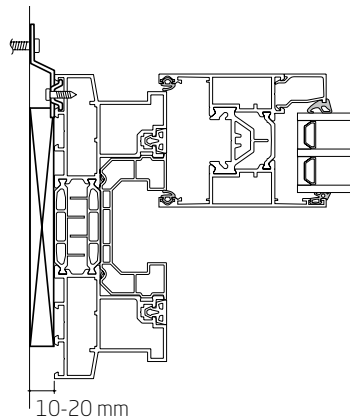
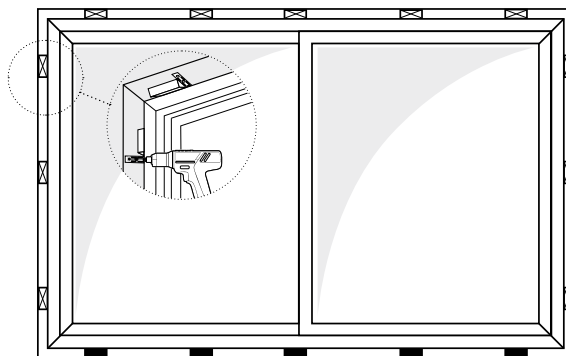

Depth of drilling according material:

100:90:80:70:60:50:40:30 | mm

Material	Drilling Depth (mm)
Concrete	30 mm
Limestone bricks	40 mm
Solide bricks	40 mm
Light Concrete	50 mm
Wood	50 mm
Porous Concrete	60 mm
Hole Bricks	100 mm

It is not recommended to fasten doors into wooden carcass due to the high risk of wood deformation due to environmental impact (Cold/Heat).

NB! All the bearing pads and wedges should be left in places!

HelAlu lift sliding doors sealing recommendations

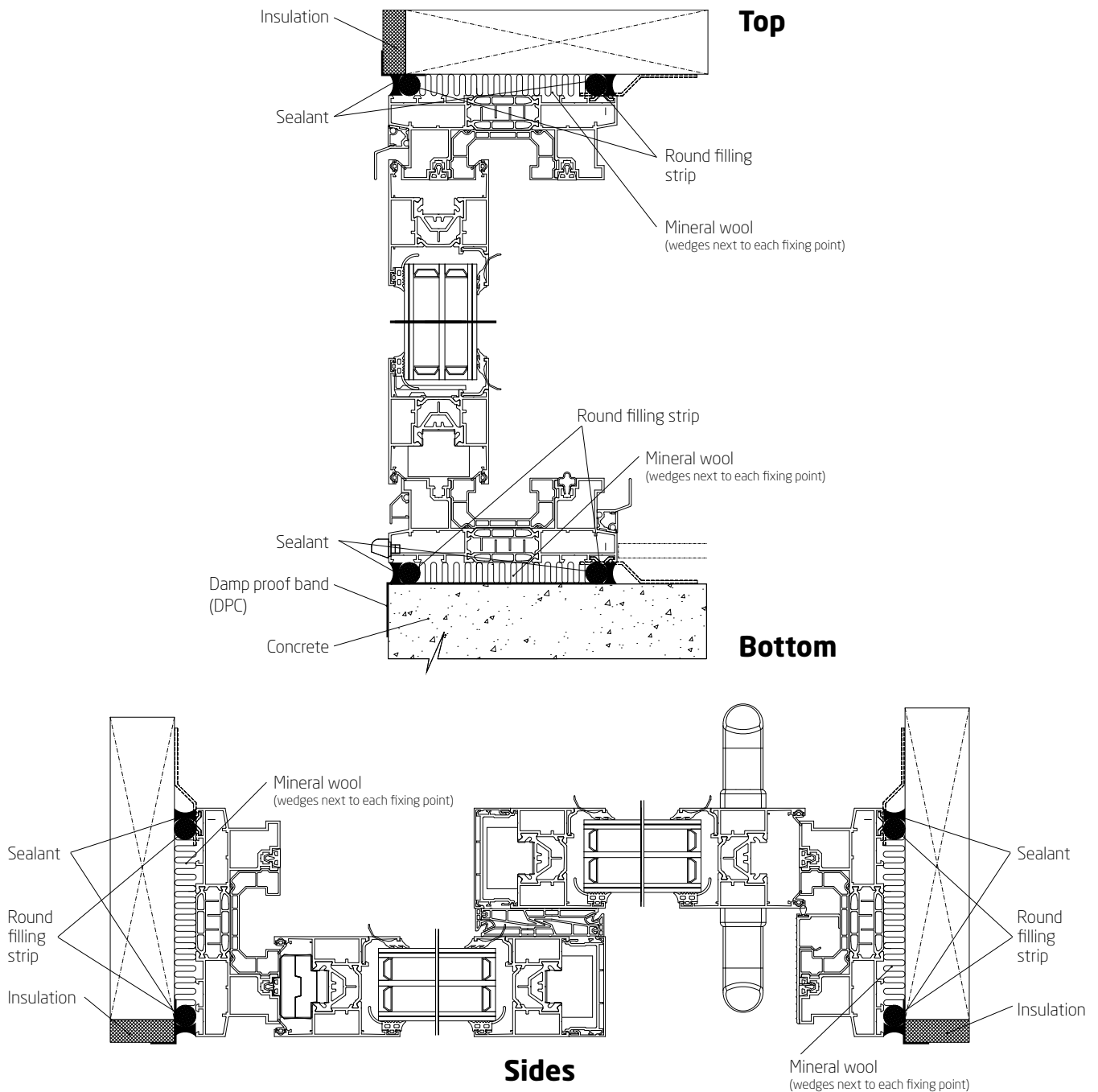

- Principle of the sealing can vary depending on the type of the wall, where construction is installed in.
- Product should not protrude outside the insulation zone of the wall.
- Water run-off, wind/draught proofing between frame and wall must be carried out in accordance with byggforsk Norway details.